

FORM No. 1.

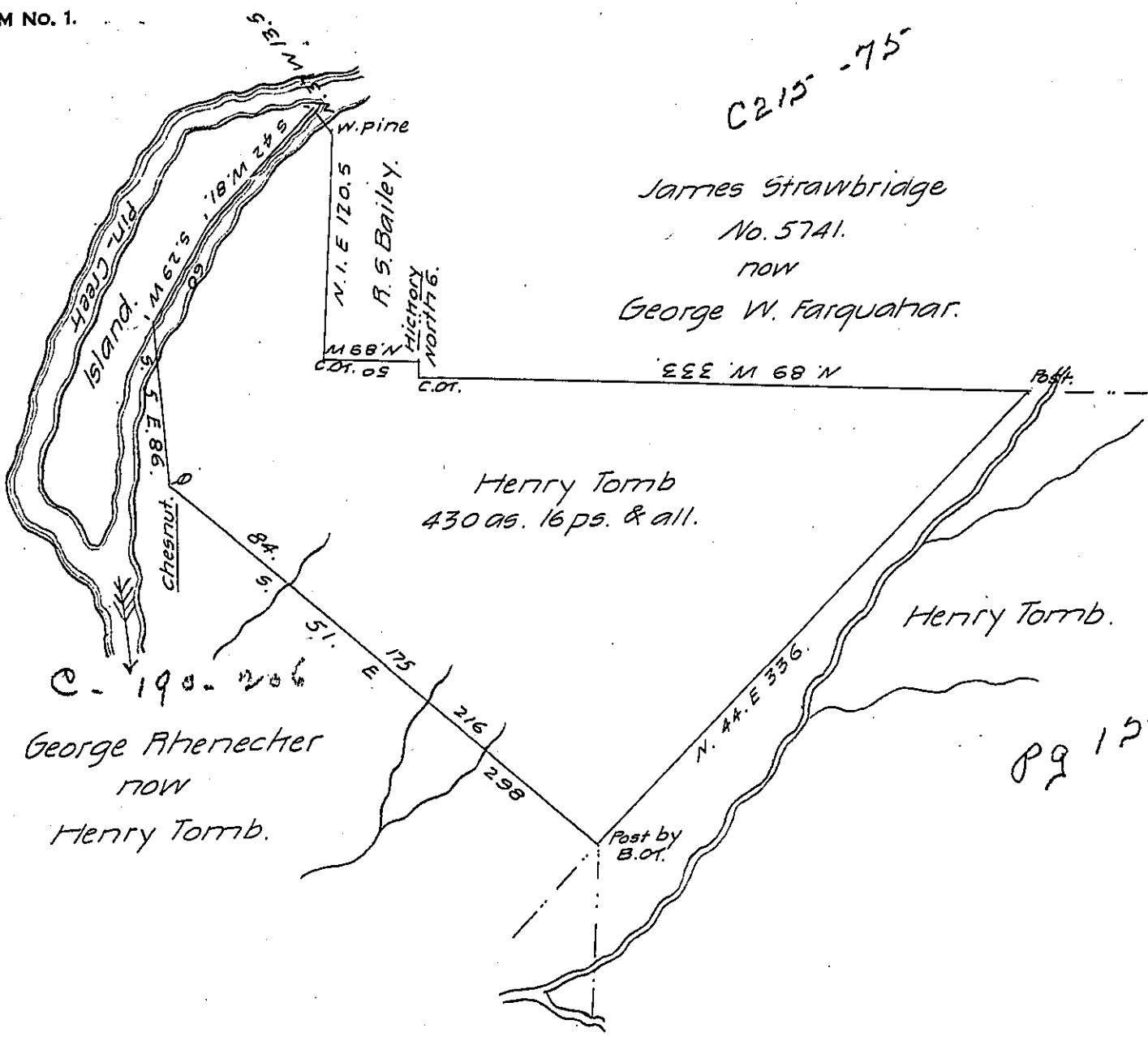

Surveyed the above described tract of land the thirtieth day of January A.D. 1839, for Henry Tomb by virtue of his warrant for 400 acres dated October 23rd 1838. Containing four hundred & thirty acres & sixteen perches & allowance of six per cent &c. Situate on the East Side of Pine Creek, and in Cummings township, Lycoming County & bounded as above described.

Note. the improvements are about 101 acres cleared land, & a house on it began in 1797.

Robert Hamilton D.S.

To John Taylor Esquire
Surveyor General.



IN TESTIMONY that the above is a copy of the original remaining on file in the Department of Internal Affairs of Pennsylvania, made conformably to an Act of Assembly approved the 16th day of February 1833, I have hereunto set my hand and caused the Seal of said Department to be affixed at Harrisburg, this eighth day of May 1907

Henry Howard
Secretary of Internal Affairs.